

# hanger systems



Product Guide

**GRIPPLE**<sup>®</sup>

# hanger systems



Sheffield Headquarters and Factory (UK)



Office and Factory (USA)



Grippple Europe Office (France)

## **G GRIPPLE®**

Grippple Limited has grown rapidly since it launched its original product in 1988. It has sold more than 230 million products to 75 countries worldwide, and now has manufacturing facilities in the UK and USA and premises in Europe.

It is an award winning company that continues to grow on the strength of its focus on innovation. The commitment to developing new products by its 'Ideas & Innovation' team has made Grippple a market leader.

Achieving high standards is paramount to Grippple, and with the entire range produced at its own manufacturing plants, quality control is guaranteed. This, combined with its strong global sales network and the assurance of millions of customers worldwide, means Grippple is well placed to meet your needs.

While its fencing and trellising products lead the agricultural and viticultural sectors, its pioneering invention of the Grippple Hanger system has also changed the face of the construction industry.

The unique Grippple Hanger has revolutionized installation techniques which can be installed both quickly and easily.

The product is used for suspending or bracing:

- mechanical & electrical services (M&E)
- heating, ventilation and air-conditioning services (HVAC)
- panels for cold rooms
- seismic bracing
- other suspended services

Grippple Hangers are used on major projects worldwide covering industrial buildings, distribution centers, sports stadia, schools, hospitals, warehouses and retail stores. In fact they can be found in some of the most prestigious projects around the world.

With its solution driven products, supported by its product knowledge and customer service, Grippple is well placed to continue leading the way in the agricultural, viticultural and construction markets.

## Contents

|                             |       |                                        |    |
|-----------------------------|-------|----------------------------------------|----|
| The Gripple Fastener        | 4     | How to choose the right size and model | 29 |
| End Fixings summary         | 5     | Manufacturer's recommendations         | 30 |
| Applications                | 6-7   | Specials/custom-made solutions         | 30 |
| End Fixings product details | 8-20  | Certified fire safe solutions          | 31 |
| Accessories                 | 21-28 |                                        |    |



## Benefits of Gripple – Savings in time and money...

The whole essence of using Gripple to suspend fixed loads is to save you time and money. Gripple is a natural replacement for threaded rod or chain for a number of reasons:

- It's fast to install (as much as six times quicker than the traditional methods)
- Versatile
- Simple to use
- Strong but lightweight
- Safe and aesthetically pleasing to the eye
- Ready to use with appropriate cable end fixings

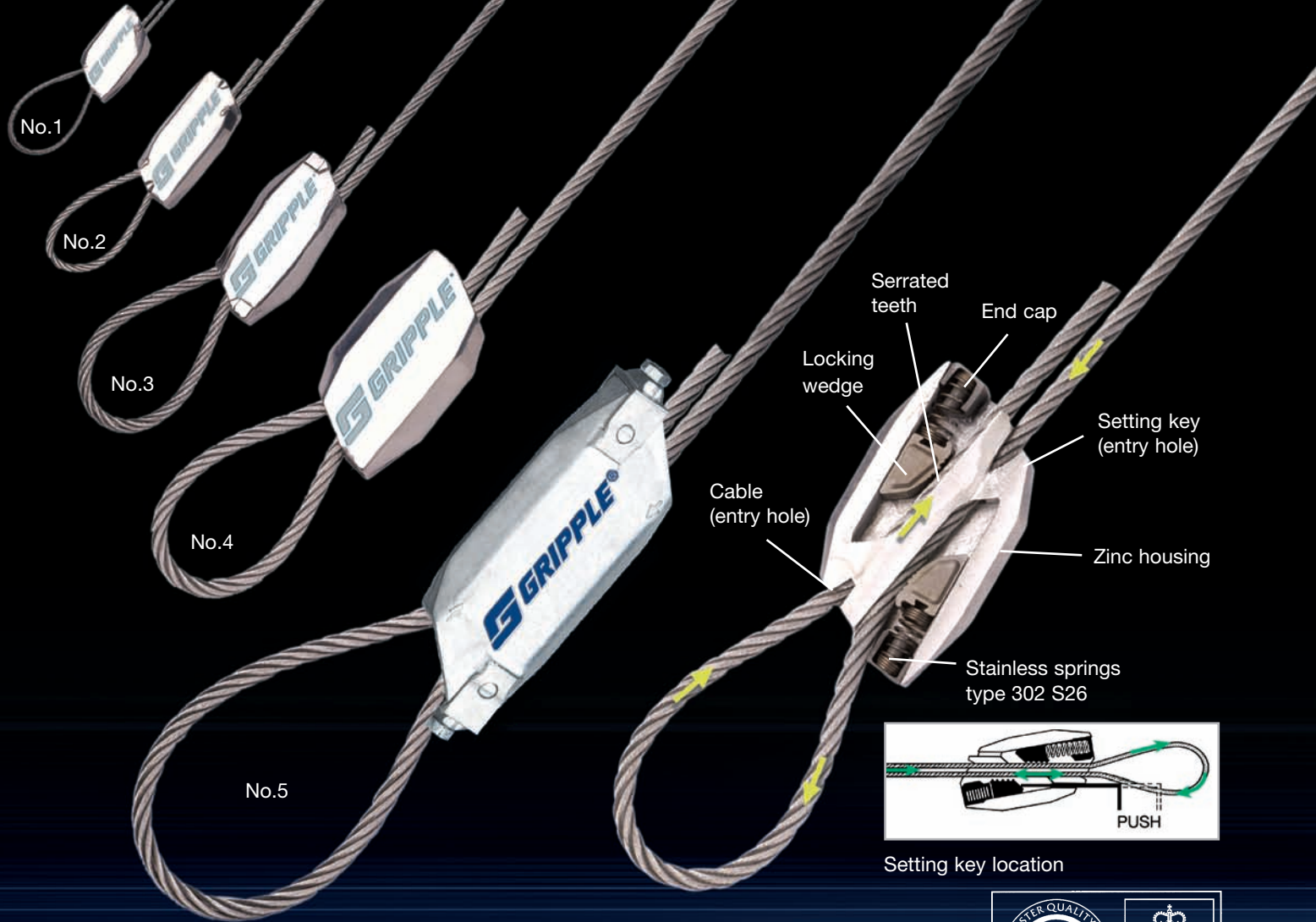

# The Gripple Fastener

The principal element of all Gripple Hanger assemblies is the Gripple fastener, for securing the cable and adjusting the height of the service.

Available in 5 hanger sizes

- ready to use kits with a choice of 8 cable end fixings
- available in lengths 5ft to 30ft as standard – other lengths on request
- stainless hangers available in loop and stud end fixings only



## Gripple Hangers: Standard Product Range

| Size | Weight Range  | SWL (safe working load) |
|------|---------------|-------------------------|
| N°1  | 0 - 22 lbs    | 22 lbs                  |
| N°2  | 22 - 100 lbs  | 100 lbs                 |
| N°3  | 100 - 200 lbs | 200 lbs                 |
| N°4  | 200 - 495 lbs | 495 lbs                 |
| N°5  | 495 - 715 lbs | 715 lbs                 |

## Gripple Hangers: Stainless Product Range

| Size | Weight Range  | SWL (safe working load) |
|------|---------------|-------------------------|
| N°2  | 0 - 100 lbs   | 100 lbs                 |
| N°3  | 100 - 200 lbs | 200 lbs                 |



# End Fixings Summary



(a)



## Loop (a)

(page 9)

For looping around bar joists, beams, roof trusses and other accessible building features. Available in sizes No.1-No.5



(b)



## Stud (b)

(page 10)

For anchoring into concrete ceilings, metal decking and pressed metal brackets (with nuts). Supplied with drop in anchors or nuts as required. Available in 1/4" in sizes No.1-No.3 and 3/8" in sizes No.3 and No.4



(c)

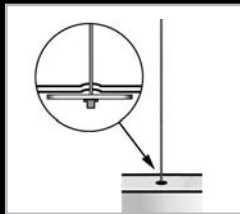

## Toggle (c)

(page 11)

For fastening through profile roof cladding, light fittings, luminaires and other cavities. Available in sizes No.1-No.3

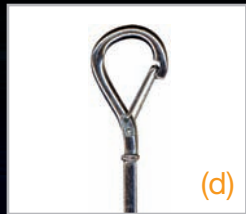

(d)



## Snap Hook (d)

(page 12)

Snap-on attachment for clips, brackets and light fittings. Available in sizes No.1-No.3

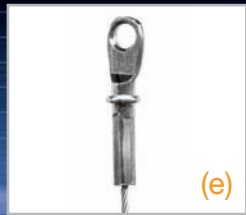

(e)

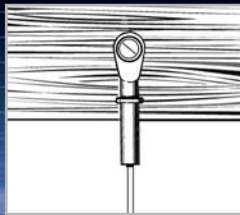

## Eyelet (e)

(page 13)

For fastening to brackets or fixtures using bolts. Available in sizes No.2 and No.3



(f)

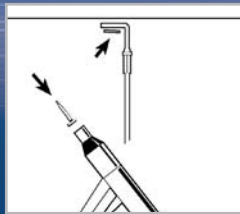

## 90° Eyelet (f)

(page 14)

Purpose designed for fixing into concrete, steel and wood. Available in sizes No.1-No.3



(g)

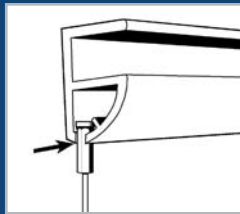

## End Stop (g)

(page 15)

Easy slide-on attachments into lighting channels and lighting track or other channel fixings. Available in sizes No.1-No.3



(h)



## Barrel (h)

(page 16)

For use in conjunction with the 1/4" T-bar twist clip for suspended ceilings or other fastenings with 1/4" male thread. Available in size No.2 only



## Electrical applications

- Busbar
- Cable ladder
- Cable tray
- Cable basket
- Conduit
- Channel
- Light rafts
- Luminaires
- Secondary supports
- Safety lines
- High wattage lights
- Electrical cables
- CCTV cameras
- Sound systems



## HVAC & Mechanical applications

- Spiral ducting
- Oval ducting
- Rectangular ducting
- Destratification fans
- Extraction ductwork
- Water pipes
- Drainage pipes
- Gas pipes
- Chill beams
- Ceiling panels
- Heating panels
- Radiant heaters

## Other applications

- Cold rooms
- Seismic bracing
- In-store signs & shopfitting
- Food factories\*
- Swimming pool environments\*
- Pest control
- Overhead catenary wires

\* Stainless steel hangers are suitable for the food industry, swimming pool environments and chemical factories.

# hanger systems



## Fixings

|                         |    |
|-------------------------|----|
| Loop End Fixing         | 9  |
| Stud End Fixing         | 10 |
| Toggle End Fixing       | 11 |
| Snap Hook End Fixing    | 12 |
| Eyelet End Fixing       | 13 |
| 90° Eyelet End Fixing   | 14 |
| End Stop Fixing         | 15 |
| Barrel End Fixing       | 16 |
| Y-Fit Fixing            | 17 |
| Y-Fit Accessory         | 18 |
| Y-Fit Pipe Hanger       | 19 |
| Trapeze Fastener System | 20 |

# Loop End Fixing



## Applications

The loop end fixing is an ideal method for choking around:

- Bar joists
- Purlins
- Beams
- Roof trusses
- Unistrut channel
- Other accessible building features

## Product Advantages

- Quick and safe choke knot installation
- No need for nuts, bolts, beam clamps, purlin clips or other accessories
- Up to 6 times faster installation compared with threaded rod, strap or chain

## Loop End Fixing Sizes

| Size  | Weight range        |
|-------|---------------------|
| No.1  | holds up to 22 lbs  |
| No.2* | holds up to 100 lbs |
| No.3* | holds up to 200 lbs |
| No.4  | holds up to 495 lbs |
| No.5  | holds up to 715 lbs |

- The above sizes have a 5:1 safety factor.
- Available in lengths 5ft to 30ft as standard – other lengths on request.

\*Stainless steel loop hangers are available in sizes No.2 and No.3.

|                           |                     |                   |                          |
|---------------------------|---------------------|-------------------|--------------------------|
| example<br>Item order No. | prefix<br><b>HF</b> | size<br><b>02</b> | - length<br><b>- 5ft</b> |
|---------------------------|---------------------|-------------------|--------------------------|

## Loop Specification

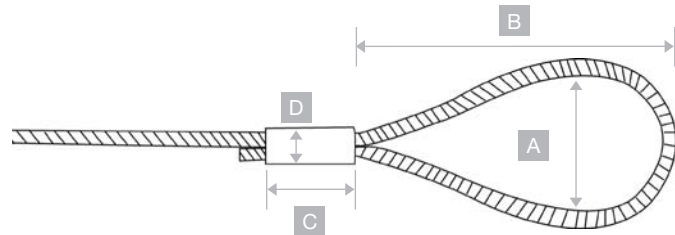

|      | A (Nominal) inches | B (Nominal) inches | C inches           | D inches         |
|------|--------------------|--------------------|--------------------|------------------|
| No.1 | 1 $\frac{3}{16}$ " | 2 $\frac{3}{8}$ "  | $\frac{3}{8}$ "    | $\frac{1}{4}$ "  |
| No.2 | 1 $\frac{3}{16}$ " | 2 $\frac{3}{8}$ "  | $\frac{1}{2}$ "    | $\frac{5}{16}$ " |
| No.3 | 1"                 | 2 $\frac{3}{8}$ "  | $\frac{5}{8}$ "    | $\frac{3}{8}$ "  |
| No.4 | 1 $\frac{3}{4}$ "  | 3 $\frac{1}{4}$ "  | 1"                 | $\frac{5}{8}$ "  |
| No.5 | 1 $\frac{3}{4}$ "  | 3 $\frac{1}{2}$ "  | 1 $\frac{5}{16}$ " | $\frac{3}{4}$ "  |

## How to Use

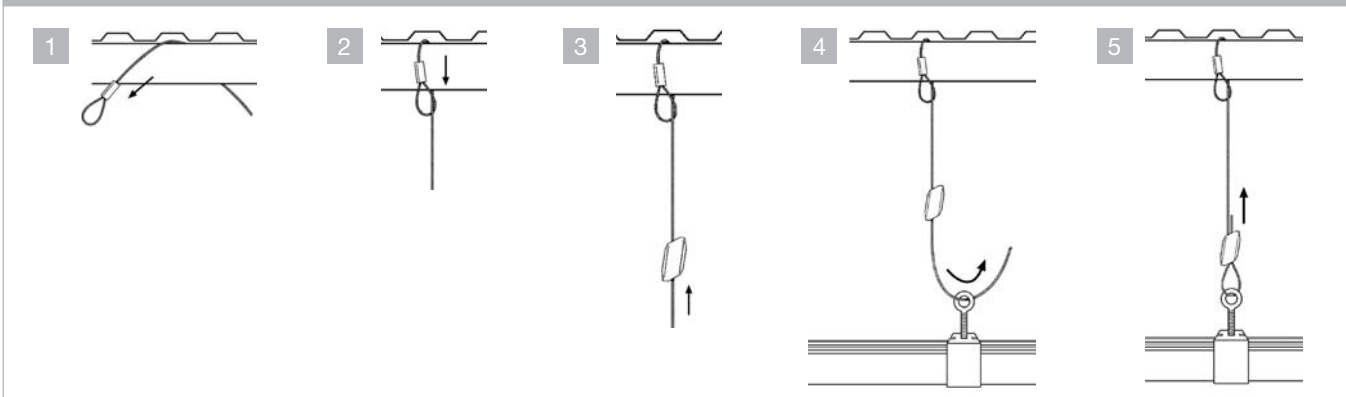

# Stud End Fixing



## Applications

The stud end fixing provides a quick method for installing services into:

- Concrete structures
- Metal decking structures
- Metal brackets using nuts
- Clamps and clevis hangers with 1/4" or 3/8" female threads

## Product Advantages

- Quick installation into concrete using drop-in anchors or nuts
- Drop-in-anchors or nuts supplied free as part of the kit
- Available in 1/4" or 3/8" sizes

## Stud End Fixing Sizes

| Size   | Weight range  | Thread       |
|--------|---------------|--------------|
| No. 2* | 22 - 100 lbs  | 1/4"         |
| No. 3* | 100 - 200 lbs | 1/4" or 3/8" |
| No. 4  | 200 - 495 lbs | 3/8"         |

- The above sizes have a 5:1 safety factor.
- Available in lengths 5-30ft as standard – other lengths on request.

\*Stainless steel stud hangers are available in sizes No.2 and No.3 with 1/4" thread only.

example  
Item order No.      prefix - size - length  
                                  **HF-SG - NO2 - 5ft**

## Stud Specification

All standard Gripple studs are manufactured from mild steel which is zinc coated for maximum anti-corrosion properties.

| A inches | B inches | C inches |
|----------|----------|----------|
| 1/4"     | 1"       | 2"       |
| 3/8"     | 1 1/4"   | 3 3/8"   |

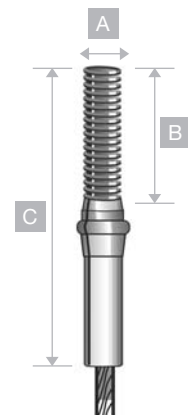

## How to Use

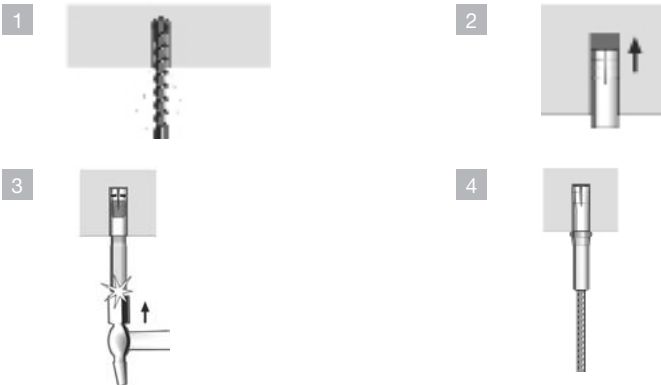

Wire Anchor  
(see page 20)

Alternative arrangement using wire anchor.

All stud products can be attached to the suspended service by using either nuts or inserting into a female thread on the service.



# Toggle End Fixing



## Applications

The toggle anchor method, which uses a restraining plate and end stop, provides an ingeniously fast way of fixing into:

- Light fittings – (including secondary supports)
- Luminaires – (including secondary supports)
- Profile roof cladding
- Other pre-drilled structures

## Product Advantages

- Unique anchor method which uses a restraining plate and end stop
- Toggle end fixing is an integral part of the rope, requiring no additional accessories
- Each size is purpose designed to fit a specific hole diameter

## Toggle End Fixing Sizes

| Size | Weight range  | ø diameter |
|------|---------------|------------|
| No.1 | 0 - 22 lbs    | 1/4"       |
| No.2 | 22 - 100 lbs  | 5/16"      |
| No.3 | 100 - 200 lbs | 7/16"      |

- The above sizes have a 5:1 safety factor.
- Available in lengths 5-30ft as standard – other lengths on request.

example  
Item order No.      prefix - size - length  
                                  **HF-TG - NO2 - 5ft**

## End Stop Specification

| Sizes | A inches | B inches | C inches |
|-------|----------|----------|----------|
| No.1  | 1/8"     | 1/4"     | 3/8"     |
| No.2  | 1/4"     | 5/16"    | 3/8"     |
| No.3  | 1/4"     | 3/8"     | 3/4"     |

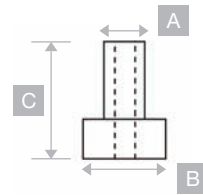

## Toggle Specification

| Sizes | A inches | B inches |
|-------|----------|----------|
| No.1  | 1/4"     | 1 1/2"   |
| No.2  | 5/16"    | 1 1/2"   |
| No.3  | 3/8"     | 2"       |



## How to Use

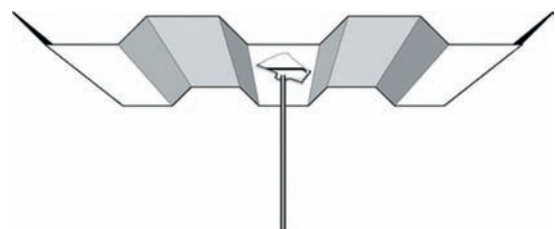
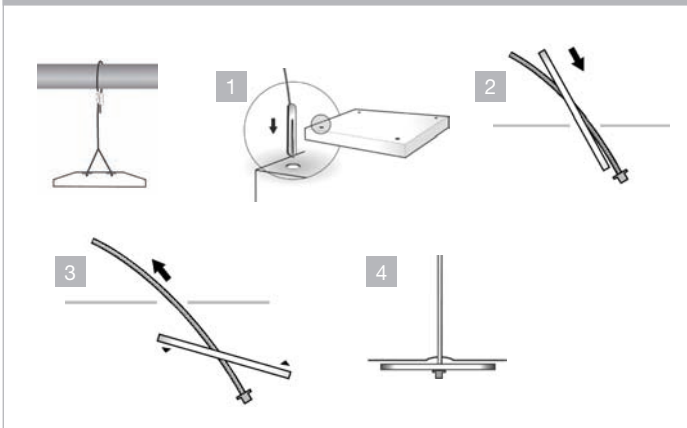

# Snap Hook End Fixing

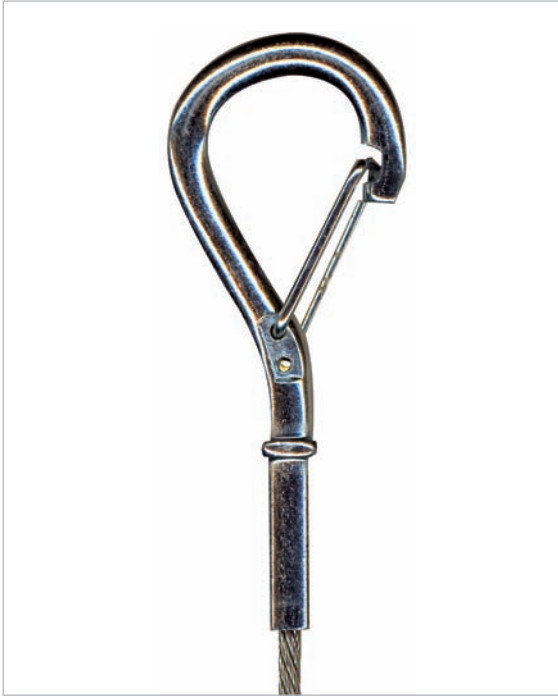

## Applications

The snap hook end fixing is a quick and ideal method for fixing to:

- Beam and purlin clips
- Any clip with a 1/4" hole
- Cable, basket and tray
- Light fittings and luminaires
- Gas radiant and infra red heaters
- Any suspended service with 1/4" minimum holes in hanging bracket

## Product Advantages

- Easy initial snap-on attachment for securing the Gripple Hanger onto an existing structure
- Ideal for services that require maintenance
- Can be attached to any clip bracket with a 1/4" hole
- Can be detached to allow loading of tray or basket with new cables

## Snap Hook End Fixing Sizes

| Size | Weight range  |
|------|---------------|
| No.1 | 0 - 22 lbs    |
| No.2 | 22 - 100 lbs  |
| No.3 | 100 - 200 lbs |

- The above sizes have a 5:1 safety factor.
- Available in lengths 5-30ft as standard – other lengths on request.

example  
Item order No.    prefix - size - length  
                          **HF-HK - NO2 - 5ft**

## Snap Hook Specification

All Gripple snap hook end fixings are zinc plated steel.

| Size | A inches | B inches | C inches |
|------|----------|----------|----------|
| No.1 | 1/4"     | 5/8"     | 3"       |
| No.2 | 1/4"     | 5/8"     | 3"       |
| No.3 | 1/4"     | 5/8"     | 3"       |

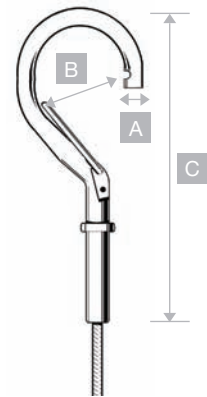

## How to Use

1

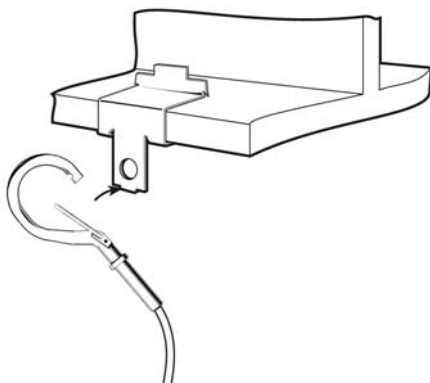

2

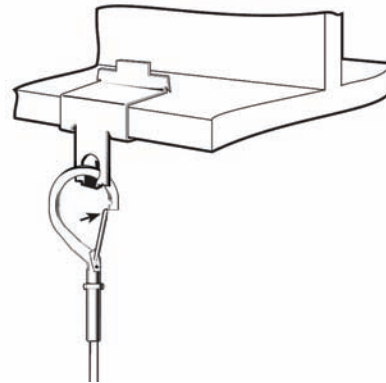

# Eyelet End Fixing



## Applications

Suitable for a variety of applications that require bolting to brackets or fixtures such as:

- Fixing sideways into wood beams using suitable woodscrew
- Speakers or visual display
- Any 1/4" bolt that is fixed for M&E services
- Light fittings
- Supporting industrial curtain track or shelter and shade netting

## Product Advantages

- Easy attachment using nuts and bolts
- Fix using a 1/4" bolt

## Eyelet End Fixing Sizes

| Size | Weight range  |
|------|---------------|
| No.2 | 0 - 100 lbs   |
| No.3 | 100 - 200 lbs |

- The above sizes have a 5:1 safety factor.
- Available in lengths 10ft and 20ft as standard – other lengths on request.

|                |               |   |            |   |            |
|----------------|---------------|---|------------|---|------------|
| example        | prefix        | - | size       | - | length     |
| Item order No. | <b>HF-EYE</b> | - | <b>NO2</b> | - | <b>5ft</b> |

## Eyelet Specification

The Gripple eyelet end fixing is made from zinc plated steel.

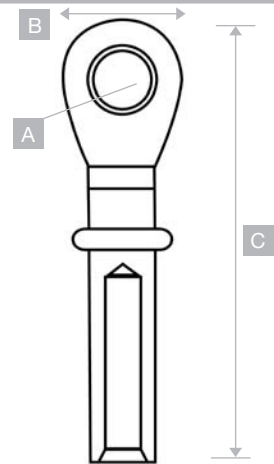

| Size | A inches | B inches | C inches |
|------|----------|----------|----------|
| No.2 | 1/4"     | 3/8"     | 1 3/4"   |
| No.3 | 1/4"     | 3/8"     | 1 3/4"   |

## How to Use

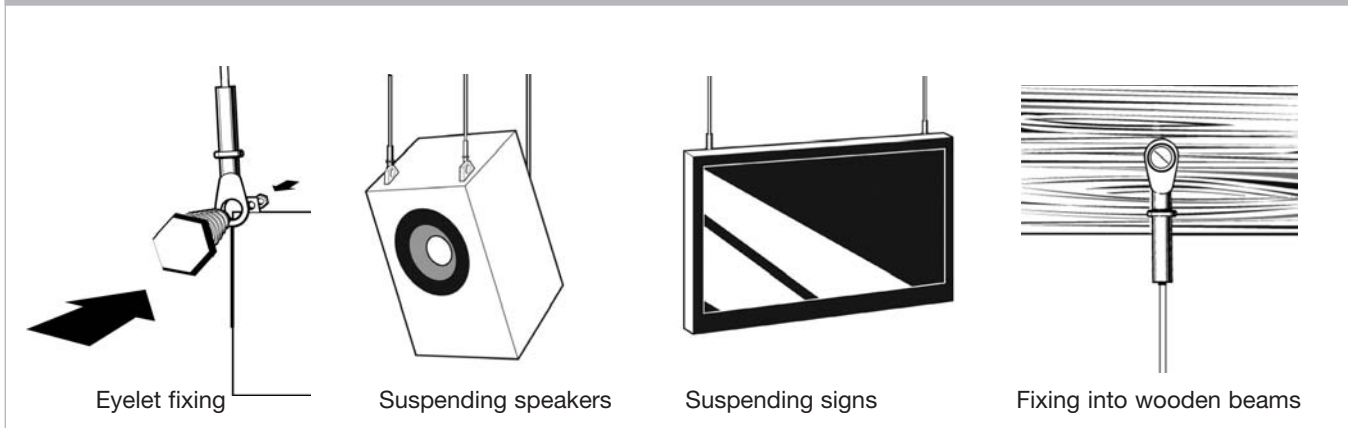

# 90° Eyelet End Fixing



## Applications

Purpose designed for fixing into concrete, steel and wood:

- Suitable for suspending all types of services
- $\frac{9}{32}$ " hole allows any suitable  $\frac{1}{4}$ " fastener or anchor to be used in concrete

## Product Advantages

- Versatile – can be attached to concrete using a variety of  $\frac{1}{4}$ " anchors or fasteners
- Designed for shot firing into concrete, steel and wood using gas and powder actuated tools
- Quick and safe saving time on installation

## 90° Eyelet End Fixing Sizes

| Size | Weight range  |
|------|---------------|
| No.1 | 0 - 22 lbs    |
| No.2 | 22 - 100 lbs  |
| No.3 | 100 - 200 lbs |

- The above sizes have a 5:1 safety factor.
- Available in lengths 5-30ft as standard – other lengths on request.

example  
Item order No.      prefix      - size - length  
                                 **HF-SEYE90G - NO2 - 5ft**

## 90° Eyelet Specification

The 90° Gripple eyelet end fixing is made from zinc plated steel.

| Size | A                | B               | C                 |
|------|------------------|-----------------|-------------------|
| No.1 | $\frac{9}{32}$ " | $\frac{7}{8}$ " | 1 $\frac{1}{2}$ " |
| No.2 | $\frac{9}{32}$ " | $\frac{7}{8}$ " | 1 $\frac{1}{2}$ " |
| No.3 | $\frac{9}{32}$ " | $\frac{7}{8}$ " | 1 $\frac{1}{2}$ " |
| No.3 | $\frac{3}{8}$ "  | 1"              | 1 $\frac{1}{2}$ " |

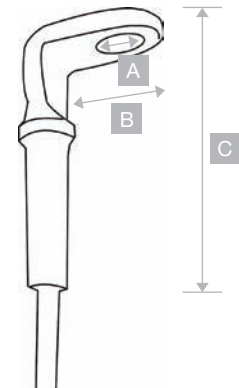

## How to Use

- 1
- 2
- 3

Light fixing

Pre-fabricated module systems

# End Stop Fixing



## Applications

The end stop fixing provides a quick and easy method for fixing to:

- Lighting channels and tracks
- Other suitable channel fixings

## Product Advantages

- Easy slide-on attachment
- Quick and easy to install

## End Stop Fixing Sizes

| Size | Weight range  |
|------|---------------|
| No.1 | 0 - 22 lbs    |
| No.2 | 22 - 100 lbs  |
| No.3 | 100 - 200 lbs |

- The above sizes have a 5:1 safety factor.
- Available in lengths 5-30ft as standard – other lengths on request.

example  
Item order No.      prefix - size - length  
                                 **HF-EG - NO2 - 5ft**

## End Stop Specification

The Gripple end stop is a mild steel, zinc coated end stop, which is pressed onto the cable.

| Size | A inches | B inches | C inches |
|------|----------|----------|----------|
| No.1 | 1/8"     | 1/4"     | 1/2"     |
| No.2 | 1/4"     | 3/8"     | 1/2"     |
| No.3 | 1/4"     | 3/8"     | 3/4"     |

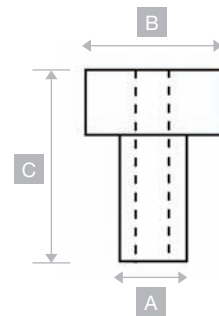

## How to Use

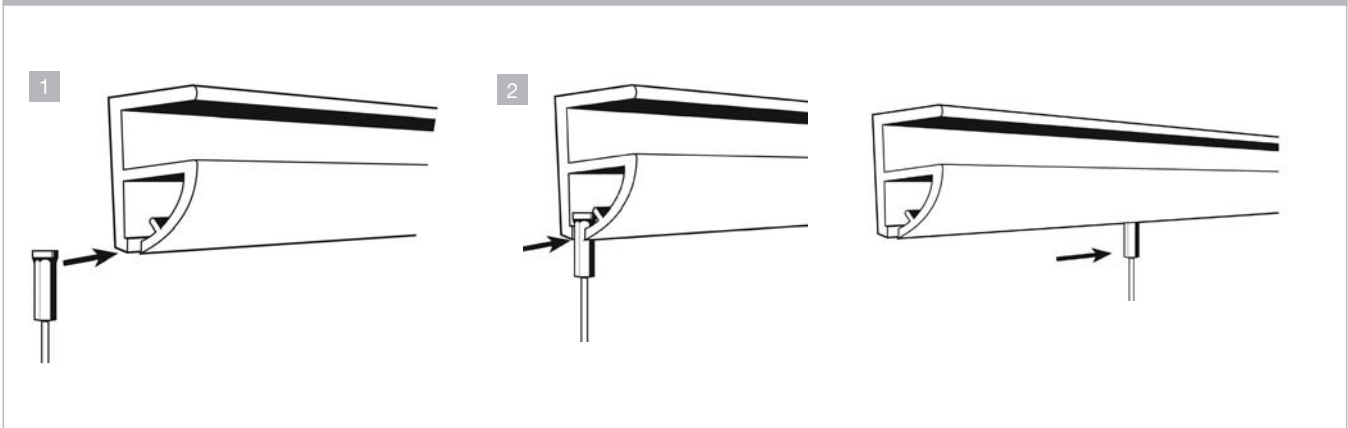

# Barrel End Fixing



## Applications

Designed to work with a 1/4" male thread, this 1/4" female threaded barrel unit is suitable for:

- Fixing signage and light fixtures to 1/4" T-bar twist clip on suspended ceilings. (See page 20)
- 1/4" bolts or screws

## Product Advantages

- Aesthetic finish provides a clean look
- Quick installation
- Screw onto 1/4" T-bar twist clip or 1/4" bolt
- Cable is an integral part of barrel fixing with an end stop

## Barrel End Fixing Sizes

| Size | Weight range |
|------|--------------|
| No.1 | 0 - 22 lbs   |
| No.2 | 22 - 100 lbs |

- The above sizes have a 3:1 safety factor.
- Available in lengths 10ft and 20ft as standard – other lengths on request.

example  
Item order No.      prefix   - size   - length  
                                 **HF-BQG - NO2 - 5ft**

## Barrel Specification

The Gripple barrel end fixing is made from zinc plated steel.

| Size | A inches | B inches | C inches |
|------|----------|----------|----------|
| No.1 | 1/4"     | 1/2"     | 1 3/16"  |
| No.2 | 1/4"     | 1/2"     | 1 3/16"  |

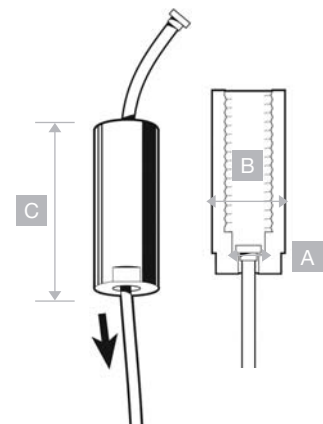

## How to Use

1

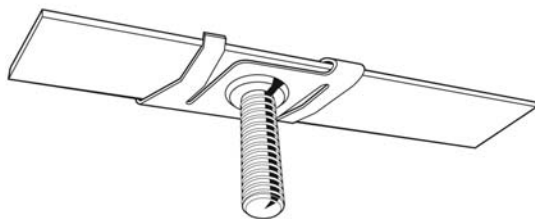

2

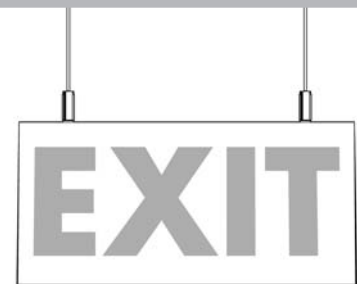
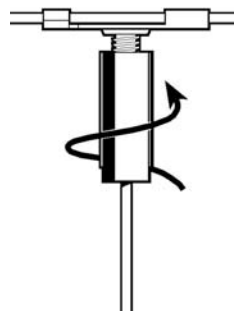

Alternative fixing arrangement.

# Y-Fit Fixing



## Applications

The Gripple Y-Fit is available in all standard Gripple end fixings and is suitable for:

- Light fixtures
- Containment – basket, ladder and tray
- Secondary or safety line support on light fixtures, luminaires, troffers and other cavity uses

## Product Advantages

- Single point suspension
- Allows two points to be suspended using one Gripple fastener
- Two legs provide stability improving the center of gravity
- Fast, easy and secure installation
- Removes the need for extra fittings such as S-hooks

## Y-Fit End Fixing Sizes

| Size  | Weight range  |
|-------|---------------|
| No.1  | 0 - 22 lbs    |
| No.2* | 22 - 100 lbs  |
| No.3* | 100 - 200 lbs |

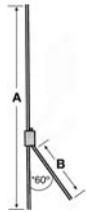

- The above sizes have a 5:1 safety factor.
- 18" legs as standard. Other lengths available on request. Please consult your sales manager
- Dimensions A and B should be specified
- A – overall length
- B – leg length

\*Stainless steel options are available in loop and stud end fixings.

## Y-Fit End Fixing Specification

Choose from End Fixings below



**90° Eyelet end fixing**  
No.1-No.3



**Eyelet end fixing**  
No.2-No.3



**End stop fixing**  
No.1-No.3



**Barrel end fixing**  
No.2



**Loop end fixing**  
No.1-No.3



**Snap hook end fixing**  
No.1-No.3



**Stud (1/4 or 3/8) end fixing**  
No.1-No.3

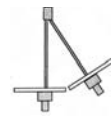

**Toggle end fixing**  
No.1-No.3

## How to Use

1

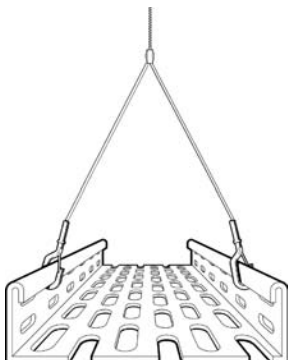

2

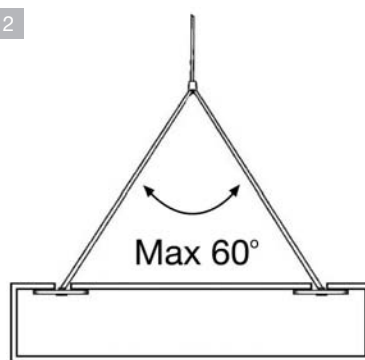

3



1. Y-Fit snap-on-hook on cable tray
2. Y-Fit toggle on light fitting
3. Y-Fit loop on light fitting

Angle between legs not to exceed 60°

# Y-Fit Accessory



## Applications

The Gripple Y-Fit Accessory is available in all standard Gripple end fixings and is suitable for:

- Containment – basket, ladder and tray
- Profile roof cladding
- Secondary or safety line support on light fittings, luminaires and other cavity uses

## Product Advantages

- Easily adjusted at working level with standard Gripple Hangers making it suitable for long drops

## Y-Fit End Fixing Sizes

| Size  | Weight range  |
|-------|---------------|
| No.1  | 0 - 22 lbs    |
| No.2* | 22 - 100 lbs  |
| No.3* | 100 - 200 lbs |

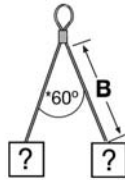

- The above sizes have a 5:1 safety factor.
- Dimension B (leg length) should be specified.
- Product made to special order.
- Please consult your local Sales Manager.
- Angle between legs not to exceed 60°

\*Stainless steel options are available in loop and stud end fixings.

## Y-Fit End Fixing Specification

Choose from End Fixings below



**90° Eyelet end fixing**  
No.1-No.3



**Eyelet end fixing**  
No.2-No.3



**End stop fixing**  
No.1-No.3



**Barrel end fixing**  
No.2



**Loop end fixing**  
No.1-No.3



**Snap hook end fixing**  
No.1-No.3



**Stud (1/4 or 3/8) end fixing**  
No.1-No.3



**Toggle end fixing**  
No.1-No.3

## How to Use

1



2

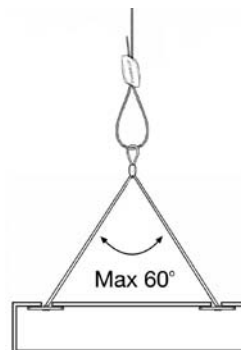

1. Y-Fit accessory on cable tray
2. Y-Fit accessory on light fitting

Angle between legs not to exceed 60°

# Y-Fit Pipe Hanger

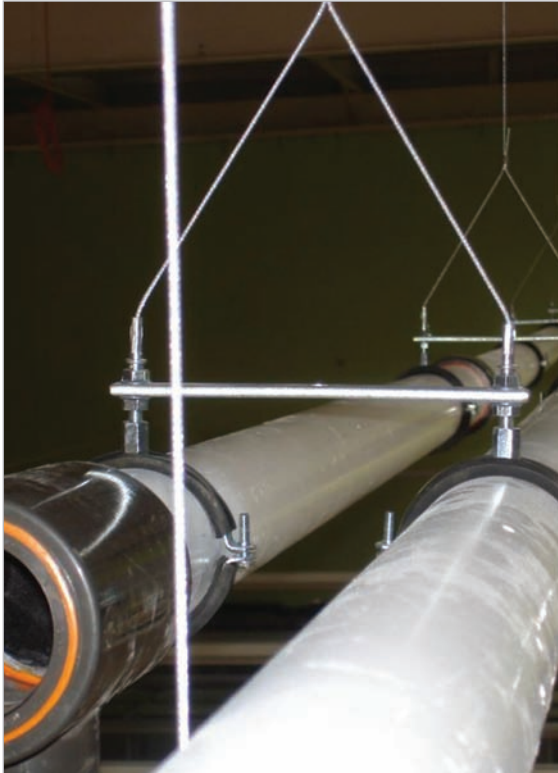

## Applications

Y-Fit pipe hanger provides a quick and easy way to suspend pipework or conduit without the need for traditional supports and bearers

- Supplied as a complete kit which consists of a  $\frac{3}{8}$ " stud Y-Fit hanger with metal support plate.
- Designed to support two pipes/conduit  $\frac{3}{8}$ "-2 $\frac{1}{2}$ ".
- Spacing allows insulation to be fitted
- Y-Fit accessory suitable for long drops with standard Gripple hanger kits.

## Product Advantages

- Quick attachment of pipe/conduit brackets to  $\frac{3}{8}$ " stud fixing
- Provides easy access to fit insulation to piping
- 50% less drilling with one single anchoring point
- Replaces conventional supports which require cutting and preparation on-site
- Ready to use kit
- Two legs provide support improving the center of gravity

## Y-Fit Pipe Hanger Fixing Sizes

- Available in Gripple Hanger size No.3
- Available in standard lengths of 5, 10, and 15ft
- Leg lengths 8"

| example<br>Item order No. | prefix          | - size       | - length             |
|---------------------------|-----------------|--------------|----------------------|
| Standard Y-Fit            | <b>HF-YSJG</b>  | <b>- NO3</b> | <b>- 5FT-0.2M-PH</b> |
| Adjustable Y-Fit          | <b>HF-AYSJG</b> | <b>- NO3</b> | <b>- 0.2M-PH</b>     |

## Y-Fit Pipe Hanger Specification

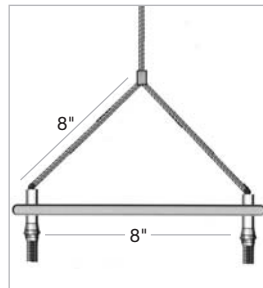

Y-Fit Pipe Hanger



Y-Fit Pipe Hanger Accessory

## How to Use

1. Fix into concrete with suitable anchor or secure around bar joist/purlin
2. Attach pipe clamps to  $\frac{3}{8}$ " studs
3. Fix pipes into pipe clamps

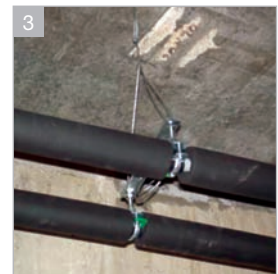
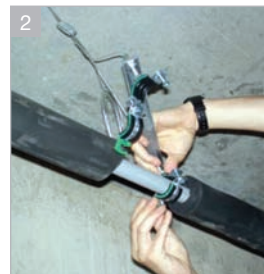

# Trapeze Fastener System



## Applications

- Suitable for low void ceilings, trapeze allows adjustment up to the ceiling
- Ideal for multi-tiered installations
- Designed as a quick and effective suspension solution for pre-fabricated units
- Suitable for supporting services in conjunction with a strut bearer

## Product Advantages

- Available as a kit in a range of end fixings (see below) in standard lengths of 5ft-30ft
- Available separately for use with standard No.3 Gripple Hanger kit for multi-tiered installations
- Rated at a SWL of 200lbs at 4:1 safety factor
- Setting pin provides easy and instant adjustment

## Multi-tiered Basket Installation

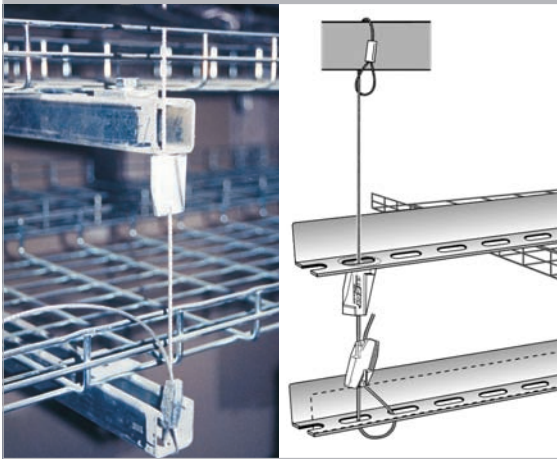

## Trapeze Fastener End Fixing Choices

|                                 |                                        |                                 |                                |
|---------------------------------|----------------------------------------|---------------------------------|--------------------------------|
|                                 |                                        |                                 |                                |
| <b>Loop end fixing (LG)</b>     | <b>Stud end fixing (SG)</b>            | <b>Toggle end fixing (TG)</b>   | <b>Hook end fixing (HKG)</b>   |
|                                 |                                        |                                 |                                |
| <b>Eyelet end fixing (EYEG)</b> | <b>90° Eyelet end fixing (SEYE90G)</b> | <b>End Stop end fixing (EG)</b> | <b>Barrel end fixing (BQG)</b> |
| example<br>Item order No.       | prefix<br><b>HF-(code as above)</b>    | - size                          | - length<br><b>5FT</b>         |

## How to Use

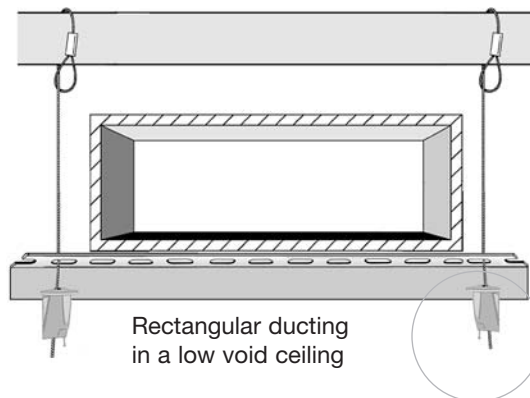

The Gripple Trapeze slots into the configuration of the channel

Setting pin can be removed after installation making it safe

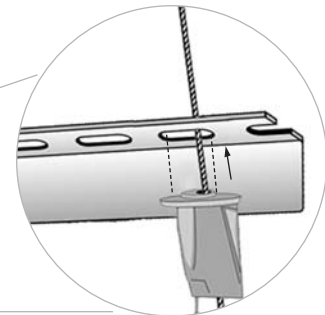

# hanger systems



## Accessories

### Fixing Solutions

22-26

- Threaded Adaptor
- Wire Anchor
- Spring Clip
- T-Bar Twist Clip
- Beam & Purlin Clips
- Pigtail Anchor Bolts
- Drop-in Anchor
- Eyebolt – Steel or Concrete
- Link Hook
- Ceiling Clip
- Ceiling Clip for wood
- Eyelet Anchor
- Karabiners

### Decorative Products

26-27

- Decor Cover
- Corner Saddle
- Trapeze Fastener
- Ceiling Fixing Kit
- Twister

### Installation Tools

28

- Tensioning Tool
- Setting Key
- Protective Sleeve Tubing
- Sleeve Tube Cutter
- Flag Key
- Setting Punch for Drop-in Anchor
- Cable Cutter

# Accessories – Fixing Solutions

## Adaptor Unit

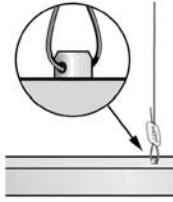
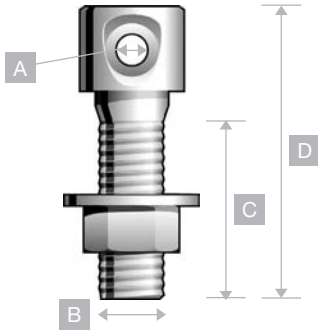

Ideal for fixing to:

- Luminaires
- Drop-in anchors
- Cable tray
- Hanging brackets
- Other services with 6mm or 8mm hole
- Available in metric sizes only
- 5:1 safety factor

Product code

HF-ADAPTOR-UNIT-M6  
HF-ADAPTOR-UNIT-M8

| A inches | B mm | C inches | D inches | Max Loads |
|----------|------|----------|----------|-----------|
| 1/8"     | 6    | 3/4"     | 1"       | 195 lbs   |
| 1/4"     | 8    | 1"       | 1 1/2"   | 495 lbs   |

## Wire Anchor

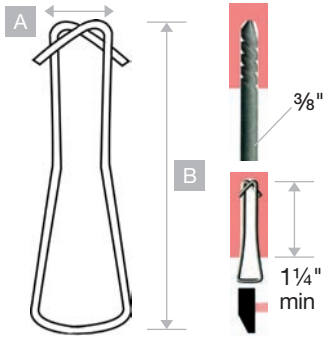

- Made from high tensile stainless steel
- The wire anchor is easily fixed into concrete
- Drill a 5/16" diameter hole to a minimum depth of 1 1/4"
- 3:1 safety factor

| Product code   | A inches | B inches | Max SWL |
|----------------|----------|----------|---------|
| HF-WIRE ANCHOR | 1/2"     | 2"       | 165 lbs |

## Spring Clip

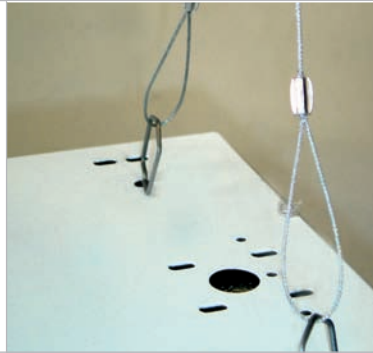
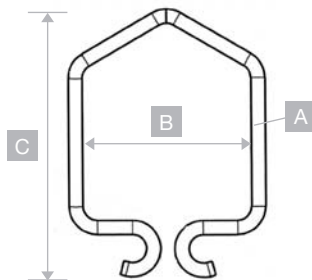

- Ideal for fixing to suspended services with 1/4" or 3/8" holes
- Spring action prevents pullout
- 3:1 safety factor

| Product code      | A inches | B inches | C inches | Max SWL |
|-------------------|----------|----------|----------|---------|
| HF-SPRING-CLIP-6  | 1/16"    | 1"       | 1 1/2"   | 100 lbs |
| HF-SPRING-CLIP-10 | 1/16"    | 1"       | 1 1/2"   | 100 lbs |

## T-Bar Twist Clip

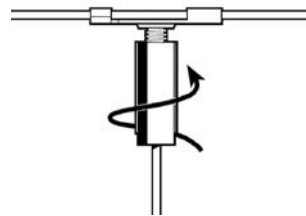
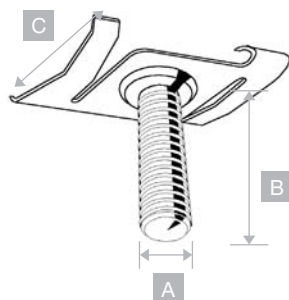

- 1/4" Twist clip for supporting fittings etc below the ceiling grid
- 3:1 safety factor

Product code

HF-TBAR-CLIP-1/4

| A inches | B inches | C inches | Max SWL |
|----------|----------|----------|---------|
| 1/4"     | 5/8"     | 1"       | 45 lbs  |

# Accessories – Fixing Solutions

## Beam & Purlin Clips



- Ideal for attaching Gripple Hangers, particularly when access or drilling restrictions are encountered.
- 3:1 safety factor

| Beam Clip                                          | Vertical Flange Clip       | Purlin Clip     | Z Purlin Clip    | Tiger Clip                                    |          |         |
|----------------------------------------------------|----------------------------|-----------------|------------------|-----------------------------------------------|----------|---------|
| <p>HF-GCB24 HF-GCB59<br/>HF-GCB1016 HF-GCB1720</p> | <p>HF-GCVF15 HF-GCVF57</p> | <p>HF-GCP45</p> | <p>HF-GCPZ48</p> | <p>HF-TIGERCLIP-2-8<br/>HF-TIGERCLIP-8-16</p> |          |         |
| Product                                            | Product code               | A inches        | B inches         | C inches                                      | D inches | Max SWL |
| <b>Beam Clip</b>                                   | HF-GCB24                   | 1/4"            | 1/16" - 5/32"    | 1 3/16"                                       | 1 3/16"  | 150 lbs |
|                                                    | HF-GCB59                   | 1/4"            | 3/16" - 5/16"    | 1 1/2"                                        | 1 1/4"   | 200 lbs |
|                                                    | HF-GCB1016                 | 1/4"            | 5/16" - 5/8"     | 1 1/2"                                        | 1 11/16" | 200 lbs |
|                                                    | HF-GCB1720                 | 1/4"            | 5/8" - 3/4"      | 1 1/2"                                        | 1 7/8"   | 200 lbs |
| <b>Vertical Flange Clip</b>                        | HF-GCVF15                  | 1/4"            | 3/64" - 3/16"    | 3/4"                                          | 2"       | 150 lbs |
|                                                    | HF-GCVF57                  | 1/4"            | 3/16" - 1/4"     | 3/4"                                          | 2"       | 150 lbs |
| <b>Purlin Clip</b>                                 | HF-GCP45                   | 1/4"            | 1/2"             | 3/4"                                          | 1 3/4"   | 45 lbs  |
| <b>Z Purlin Clip</b>                               | HF-GCVZP48                 | 1/4"            | max 1/10"        | 5/8"                                          | 2 1/2"   | 100 lbs |
| <b>Tigerclip</b>                                   | HF-TIGERCLIP-2-8           | 1/4"            | 1/16" - 5/16"    | 3/16"                                         | –        | 260 lbs |
|                                                    | HF-TIGERCLIP-8-16          | 1/4"            | 5/16" - 5/8"     | 1 1/2"                                        | –        | 260 lbs |

## Pigtail Anchor Bolts

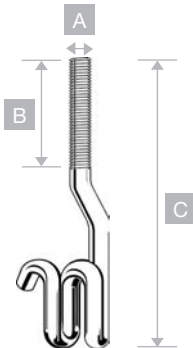

- Fast loop-on fixing for the Gripple loop end hanger
- Available in metric sizes only
- 5:1 safety factor

| Product code       | A mm | B inches | C inches | Max Loads |
|--------------------|------|----------|----------|-----------|
| HF-PIGTAIL-20MM-M6 | 6    | 3/4"     | 4"       | 200 lbs   |
| HF-PIGTAIL-45MM-M6 | 6    | 1 3/4"   | 4 1/2"   | 200 lbs   |
| HF-PIGTAIL-45MM-M8 | 8    | 1 3/4"   | 4 1/2"   | 330 lbs   |

# Accessories – Fixing Solutions

## Drop-in Anchor

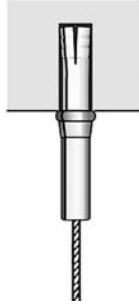
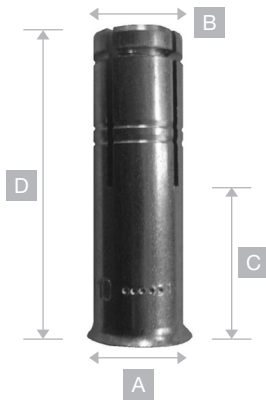

- Punch activated Grip L anchors for fixing into concrete and hollow core ceiling slabs
- All stud kits include free drop-in anchors
- A minimum of 1" concrete is required
- ETA approved
- 5:1 safety factor

| Product code         | A inches | B inches | C inches | D inches | Max SWL |
|----------------------|----------|----------|----------|----------|---------|
| HF-DROPIN-ANCHOR-UNC | 1/4"     | 5/16"    | 1/2"     | 3/16"    | 200 lbs |
| HF-DROPIN-ANCHOR     | 3/8"     | 1/2"     | 9/16"    | 19/16"   | 495 lbs |

## Eyebolt

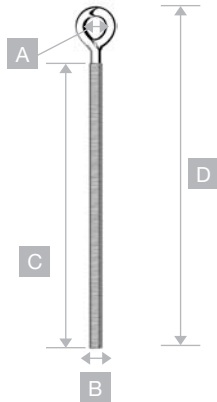

- Available in two sizes, M8 or M10, and each can be either full or part threaded
- Can be used with a nut or drop-in anchor
- Available in metric sizes only
- 5:1 safety factor

| Product code            | A inches | B mm | C inches | D inches | Max SWL |
|-------------------------|----------|------|----------|----------|---------|
| EYEBOLT-M8-200MM-98MM   | 5/8"     | 8    | 3 3/4"   | 9"       | 495 lbs |
| EYEBOLT-M8-0.2M-F/THR   | 5/8"     | 8    | 7 1/2"   | 9"       | 495 lbs |
| EYEBOLT-M8-130MM-F/THR  | 5/8"     | 8    | 5 1/8"   | 6 3/4"   | 495 lbs |
| EYEBOLT-M10-200MM-98MM  | 5/8"     | 10   | 3 3/4"   | 9"       | 495 lbs |
| EYEBOLT-M10-0.2M-F/THR  | 5/8"     | 10   | 7 1/2"   | 9"       | 495 lbs |
| EYEBOLT-M10-130MM-F/THR | 5/8"     | 10   | 5 1/8"   | 6 3/4"   | 495 lbs |

## Link Hook

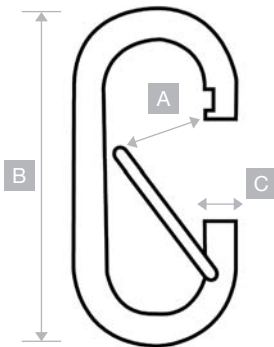

- Easily attached to any loop end hanger
- Ideal for fixing to cable trays
- 3:1 safety factor

| Product   | A inches | B inches | C inches | Max SWL |
|-----------|----------|----------|----------|---------|
| LINK-HOOK | 3/4"     | 2 3/8"   | 1/4"     | 200 lbs |

# Accessories – Fixing Solutions

## Ceiling Clip

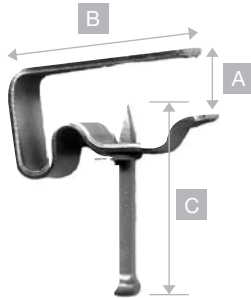

- Loop end fixing simply engages in the valley of the clip
- Available with plastic and metal washers for concrete and steel
- After firing, the nail completely entraps the Gripple loop fixing, but still allows pivotal movement of the cable
- Weight loadings are dependent on the type of concrete/steel
- Always carry out a pull-test on site to determine the weight loadings

| Product code               | A inches | B inches | C inches | Max SWL |
|----------------------------|----------|----------|----------|---------|
| HF-CLIP-P19 (M19) Steel    | 5/8"     | 1 1/4"   | 3/4"     | 200 lbs |
| HF-CLIP-P32 (M32) Concrete | 5/8"     | 1 1/4"   | 1 1/4"   | 200 lbs |

## Ceiling Clip for wood

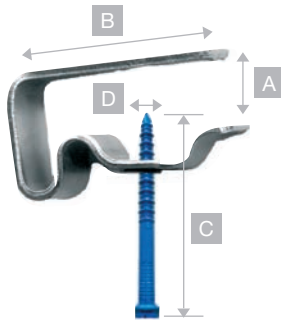

- Loop end fixing simply engages in the valley of the clip
- Drill 3/16" hole to a minimum depth of 1"
- Fix the screw using an 8mm socket
- Also available: Drive thru<sup>®</sup> socket for attachment to drill (HF-socket-6.5mm)

| Product code | A inches | B inches | C inches | D inches |
|--------------|----------|----------|----------|----------|
| HF-CLIP-W32  | 5/8"     | 1 1/4"   | 1 1/4"   | 1/4"     |

## Eyelet Anchor – Self Expanding

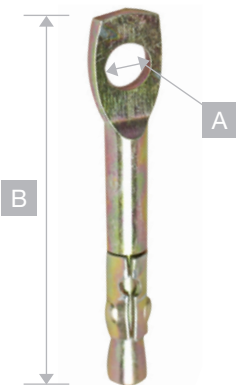

- Self-expanding eyelet anchor
- Drill 1/4" hole to 1-11/16" depth and hammer into concrete
- To set, tug with a claw hammer
- 3:1 safety factor

| Product code | A inches | B inches | Max SWL |
|--------------|----------|----------|---------|
| HF-CWH6      | 1/4"     | 2 1/8"   | 100 lbs |

# Accessories – Fixing Solutions/Decorative Products

## Karabiners

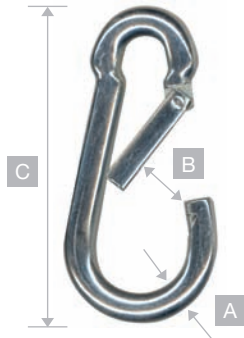

- For use with loop end hangers
- Also available in stainless steel
- 3:1 safety factor

| Product code          | A inches | B inches | C inches | Max SWL |
|-----------------------|----------|----------|----------|---------|
| HF-CARBINE HK 6/60    | 1/4"     | 3/8"     | 1 3/8"   | 100 lbs |
| HF-CARBINE HK 6/60 SS | 1/4"     | 3/8"     | 1 3/8"   | 100 lbs |
| HF-CARBINE HK 8/80    | 5/16"    | 3/8"     | 3 1/8"   | 200 lbs |
| HF-CARBINE HK 8/80 SS | 5/16"    | 3/8"     | 3 1/8"   | 200 lbs |

## Decor Cover

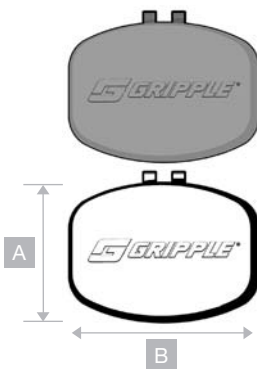

- An aesthetic snap-fit plastic cover which protects the Gripple from the ingress of paint
- Available in two versions to fit sizes No.2 and No.3

| Product code       | A inches | B inches |
|--------------------|----------|----------|
| HF-DECOR-COVER-NO2 | 1 5/8"   | 1 3/8"   |
| HF-DECOR-COVER-NO3 | 1 5/8"   | 1 3/8"   |

## Corner Saddle

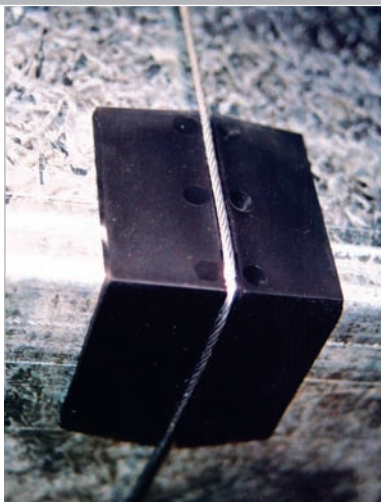
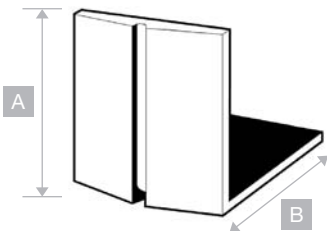

- A right-angled reinforcement moulding for positioning and supporting Gripple Hangers sizes No.1-No.3
- Designed for rectangular ductwork

| Product code     | A inches | B inches |
|------------------|----------|----------|
| HF-CORNER-SADDLE | 2"       | 2"       |

# Accessories – Decorative Products

## Trapeze Fastener

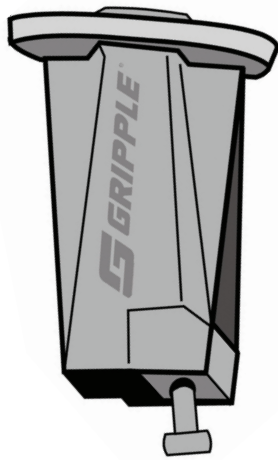

- Purpose-made one-way Gripple for use on Gripple Hanger
- Load rated at 200 lbs
- Ideal for multi-tiered installations
- 5:1 safety factor

Product code

HF-TRAPEZE-NO3-REL

## Ceiling Fixing Kit

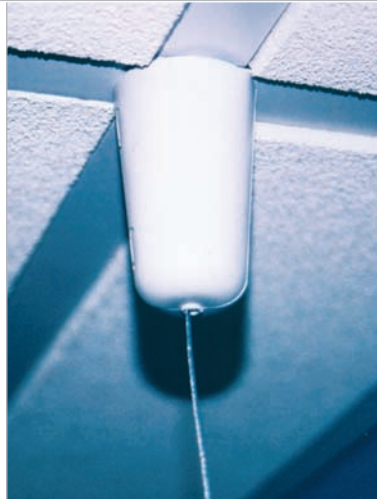
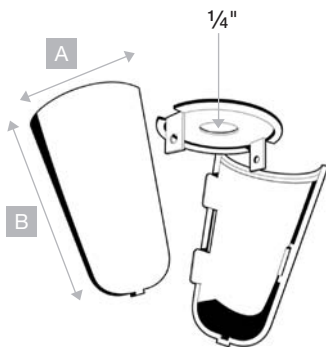

- A decorative ceiling fixing
- Ideal when suspending luminaires and lighting in offices, public buildings or retail premises
- 5:1 safety factor

| Product code     | A inches | B inches | Max SWL |
|------------------|----------|----------|---------|
| HF-CEILING COVER | 3/8"     | 1 3/8"   | 22 lbs  |

## Twister

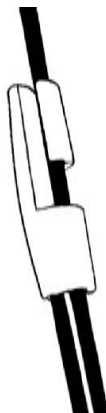

- New innovative system for securing tail wires
- Tough, safe, simple and tidy
- Suitable for use with sizes No.2 and No.3
- Can be fitted retrospectively

Product code

TWIST-100B

# Accessories – Installation Tools

## Tensioning Tool



- A purpose-made tool for quickly tensioning the cable
- Suitable for use on the higher rated hanger sizes No.4 and No.5
- Applies up to 880 lbs of load

Product code

TOOL-3-6MM-LOCK-1BX

## Setting Key



- Easy grip setting key for use with Gripple kits
- Available in two sizes for No.1-No.3 and No.4-No.5

Product code

KEY-HF-LOGO-NO1/NO3

KEY-HF-LOGO-NO4/NO5

## Flag Key



- Setting Key for use with No.1-No.3

Product code

KEY GP/FLAG

## Protective Sleeve Tubing



- Protective black plastic sleeve tubing to further reduce risk of condensation
- Suitable for use with Gripple Hanger sizes No.2 and No.3

Product code

HF-SLEEVE-2MM (No.2)

HF-SLEEVE-3MM (No.3)

## Setting Punch for Drop-in Anchor



- Available in 3 sizes M6, M8 and M10 for use with Drop-in anchor

Product code

HF-SET-PUNCH-M6

HF-SET-PUNCH-M8

HF-SET-PUNCH-M10

## Sleeve Tube Cutter



- For cutting the sleeve tubing to length
- Cuts both 2mm and 3mm tubing

Product code

CUTTER-HOSE

## Cable Cutter

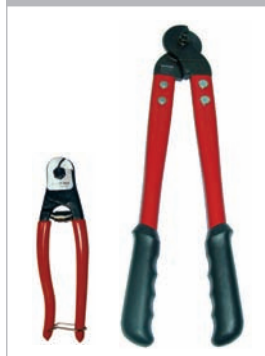

- A purpose-made tool for cutting cable
- Regular cutter suitable for use on the Gripple range sizes No.1-No.4
- 6mm cutter suitable for No.5

Product code

CUTTER-GRIPPLE

CUTTER-GRIPPLE-6MM

# How to choose the right size and model

1. Choose the size where the object's weight falls within the product's working range. Examples of the calculation formula are detailed below.
2. Unless specified, each of our end fixings maintains the load ratings of the individual kits.
3. Each size has a specified safe working load rated at 5:1, and offers a working load range.
4. The load range should be observed; choosing a size that is lighter or heavier than necessary is counter-productive, both functionally and financially.
5. Remember to adjust your size choice if the hanger is to be used at an angle other than vertical. The table below (effect on SWL of hanging objects at an angle) shows the effect a sideways load has on a vertical installation.
6. In areas of high humidity (a paper factory) and frequent wash down (a food processing factory), stainless steel kits should be considered for extended life performance.

## Calculation formula

How to specify the right size:

### Weight per ft x distance between hangers

**Example 1:** 20 lb load per foot  
 $20 \times 5 = 100 \text{ lbs}$  → Distance between hangers is 5ft  
 Plane: vertical  
**Size will be No.2**

**Example 2:** 60 lb load per foot  
 $60 \times 5 = 300 \text{ lbs}$  → Distance between hangers is 5ft  
 Plane: vertical  
**Size will be No.4**

### Effect on SWL of hanging objects at an angle

The load rating for a Gripple Hanger is based on the suspension being hung vertically. If the wire rope is suspended at an angle, an additional sideways load is applied which reduces the load capacity of the suspension. The net effect is shown in the table below:

| Maximum SWL (lbs) at an angle form vertical |             |     |     |     |     |
|---------------------------------------------|-------------|-----|-----|-----|-----|
| Gripple Hanger                              | 0° vertical | 15° | 30° | 45° | 60° |
| No.1                                        | 22          | 21  | 18  | 15  | 11  |
| No.2                                        | 100         | 96  | 86  | 70  | 50  |
| No.3                                        | 200         | 192 | 172 | 140 | 100 |
| No.4                                        | 495         | 475 | 425 | 346 | 247 |
| No.5                                        | 715         | 686 | 614 | 500 | 357 |
| Load %                                      | 100         | 96  | 86  | 70  | 50  |

# Manufacturer's recommendations

**Environment** – Standard Gripple Hangers may be used only in dry locations. Stainless steel Gripple Hangers may be used in certain indoor corrosive environments such as properly ventilated swimming pool arenas.

**Load** – Do not exceed the Safe Working Load (SWL) of any Gripple product.

**No lifting** – Do not use for lifting, such as in a crane or pulley situation.

**No movement** – Gripple Hangers are to be used to suspend static loads only. Do not use to suspend moving services, or services likely to be subject to movement.

**No joining** – Gripple Hangers must not be spliced together using a Gripple fastener, or any other joining device. A Gripple Hanger assembly must comprise one length of cable and one Gripple fastener only. If a longer length is needed, do not attempt to join two assemblies together.

**Limitations of use** – All Gripple Hangers, accessories and other Gripple products must only be used for suspending items recommended by the manufacturer.

**Painting** – If painting, ensure that a Gripple Décor Cover is applied to the Gripple fastener before painting to protect from the ingress of paint. Do not move the Gripple fastener on the cable after painting.

**Building codes** – Compliance with local codes, and where applicable national codes, is the buyer and/or installers responsibility.

**Lubricants** – Do not apply oil or any other lubricant to any part of the assembly

**Round duct/pipes** – When wrapping around duct or other round pipes, do not exceed an angle of 60 degrees between the top of the pipe and the Gripple.

**Not for re-use** – Gripple Hangers are designed for permanent installations, not for re-use.

**Y-Fit installation angle** – Legs on Y-fit hangers not to be installed at angles greater than 60 degrees.

*Failure to observe these usage instructions may result in product malfunction, resulting in property damage and bodily injury. At time of shipment Gripple products are warranted to conform to the manufacturer's published specifications and to be free from defects in material and workmanship. No other warranty, whether expressed or implied, including any warranty of merchantability or fitness for purpose, whether expressed or implied, shall exist in connection with the sale or use of any Gripple product.*

## General Guidelines for Swimming Pool Environments

- Please be aware of stress corrosion cracking (SCC) in swimming pool environments.
- In order to safeguard against SCC, please ensure at least two inspections are carried out each year of Safety critical components by a competent third party.
- Gripple cannot guarantee its products against SCC due to the high levels of inspection and maintenance required.

All the above information is taken from the Health and Safety Executive (HSE) report published in 1995 relating to swimming pool environments.

# Specials/custom-made solutions

We are specialists in solving our customers' problems by offering a number of custom-made hanger solutions. We control all of our manufacturing at our award winning ISO 9002 factory, and can custom make virtually any type of wire end fixing, or offer a number of accessories which meet customers' needs. Please contact us to discuss specific requirements.

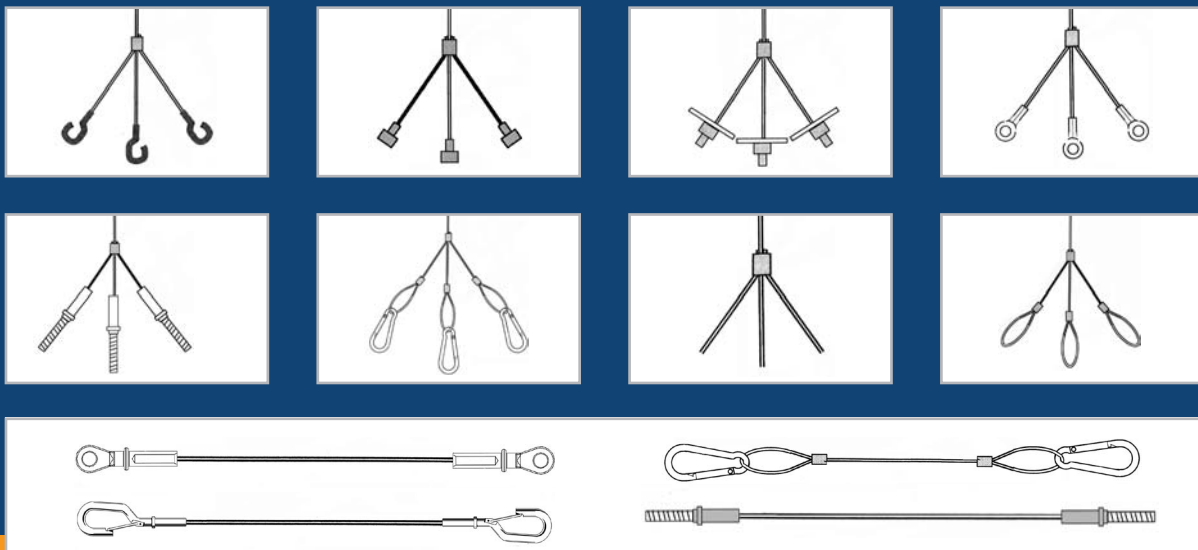

# hanger systems

## Certified fire safe solutions

### Standard Range – Temperature tested

- Standard range of No.1-No.3 Gripple Hangers have been tested at 250° C
- The test was independently witnessed by Chiltern International Fire Ltd
- Maximum rating of 60 minutes applies to the 3 sizes



### Stainless Steel – Fire certified DIN Standard

- Stainless range of No.2 and No.3 Gripple Hangers have been tested to DIN 4102-2 "Fire Behaviour of Building Materials and Building Components"
- The test has been independently witnessed by Intertek Testing Services
- Maximum rating of 44lbs for 30 minutes achieved for the No.2 Gripple Hanger
- Maximum rating of 132lbs for 45 minutes achieved for the No.3 Gripple Hanger

Intertek



**For further details contact:**

Grippple Inc.  
1611 Emily Lane  
Aurora, IL 60502  
USA

Tel: + 1 800 654 0609  
Fax: + 1 800 654 0689  
Email: [gripppleinc@grippple.com](mailto:gripppleinc@grippple.com)

Grippple Ltd. (Headquarters)  
The Old West Gun Works  
Savile Street East  
Sheffield S4 7UQ  
England

Tel: +44 (0)114 275 2255  
Fax: +44 (0)114 275 1155  
Email: [info@grippple.com](mailto:info@grippple.com)

Grippple Europe S.à.r.l  
1, rue du commerce  
BP 37  
F67211 Obernai Cedex  
France

Tel: +33 (0)3 88 95 44 95  
Fax: +33 (0)3 88 95 08 78  
Email: [frinfo@grippple.com](mailto:frinfo@grippple.com)

Grippple GmbH  
Sophienstrasse 22  
D76530 Baden-Baden  
Germany

Tel: +49 (0)700 95 44 95 11  
Fax: +49 (0)700 95 08 78 11  
Email: [frinfo@grippple.com](mailto:frinfo@grippple.com)



*Grippple® is a registered trademark of Grippple Limited.  
World patented. Made in Sheffield UK.*

**MAN-HF-PRODUCT08-USA**

[www.grippple.com](http://www.grippple.com)